



## Application

Flamgard's Inlet Vane dampers are rigidly designed to meet the industry demands of zero downtime and low maintenance. They save energy by allowing the rotor to turn at start-up without air loading; and running the radial vanes at an optimum angle causing the incoming air to 'swirl' in the running direction of the turning fan rotor.

## Structure and Dimensions

Certain units in the range can be manufactured in sizes up to 2000mm diam. Standard units are constructed in 304 or 316 stainless steel, however it is possible to manufacture in mild steel, galvanised steel or other materials as required.

### Certifications

- Dampers in this range have been tested for operation in temperatures up to 150 deg C.



## Range

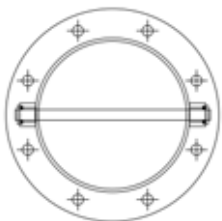

CVC-C1 - Circular Inlet Vane Control Damper



CVC-01 - Inlet Vane Control Damper